

Welcome to your natural home experience.
Take your time, choose your favorite plant and the perfect place to start a new way of living with Natede.

Assembly Time: 15 minutes

What's in the box

In the box, you will find the following components.
Otherwise, contact us at support@vitesy.com.

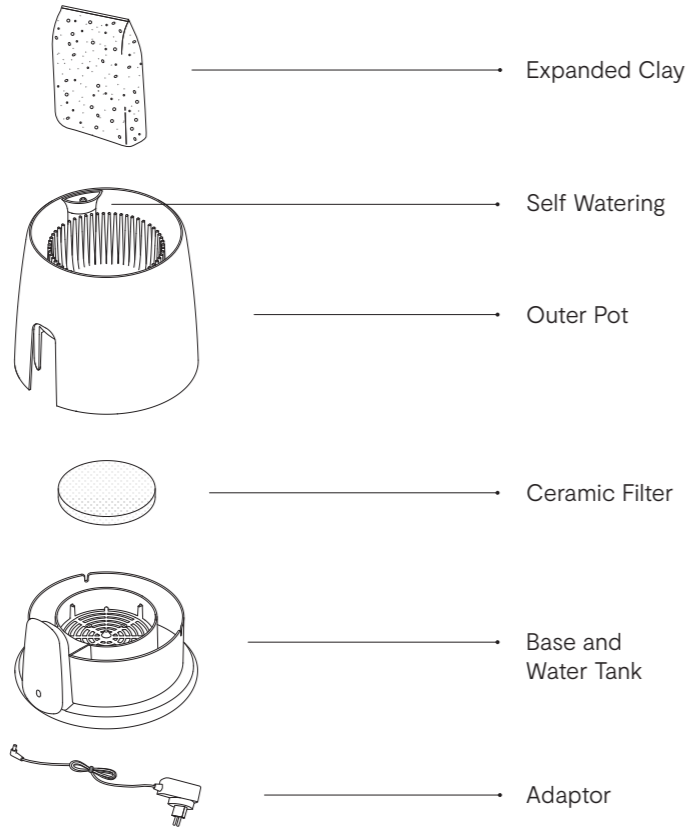

1 → check the rope

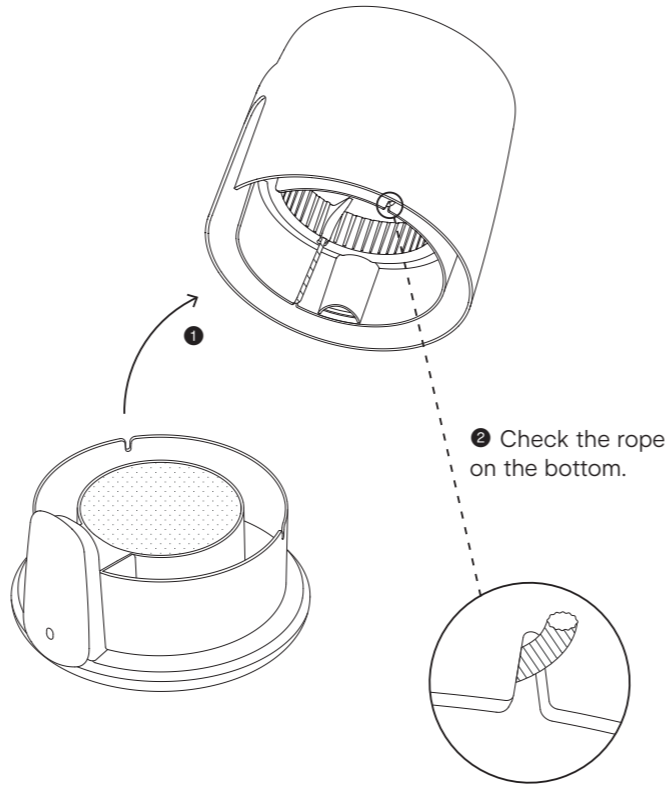

Pull out the outer pot from the base ① and then make sure that the rope is placed correctly in the grooves under the pot ②.

2 → plug it

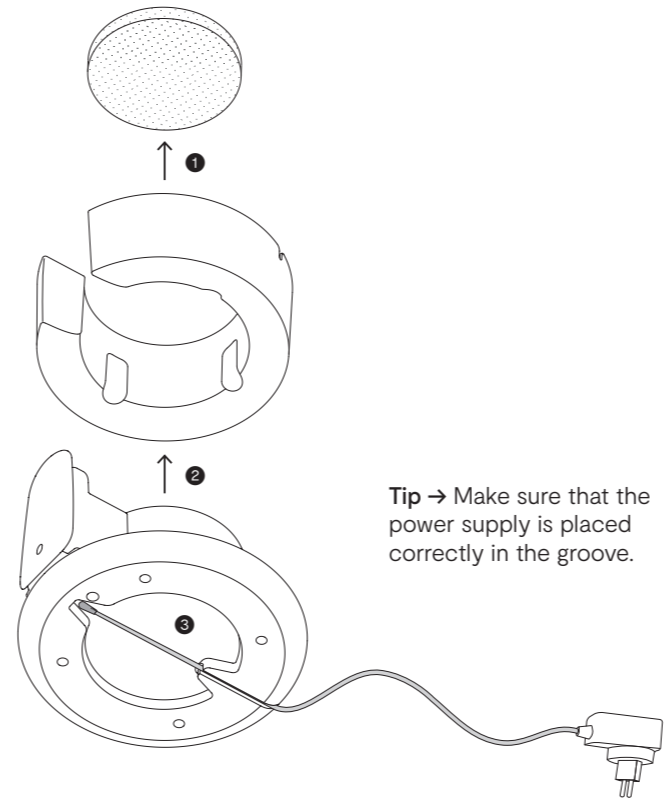

Remove carefully the ceramic filter ① and the water tank ② from the base, turn it upside down and plug in the power supply ③.

3 → fill with clay

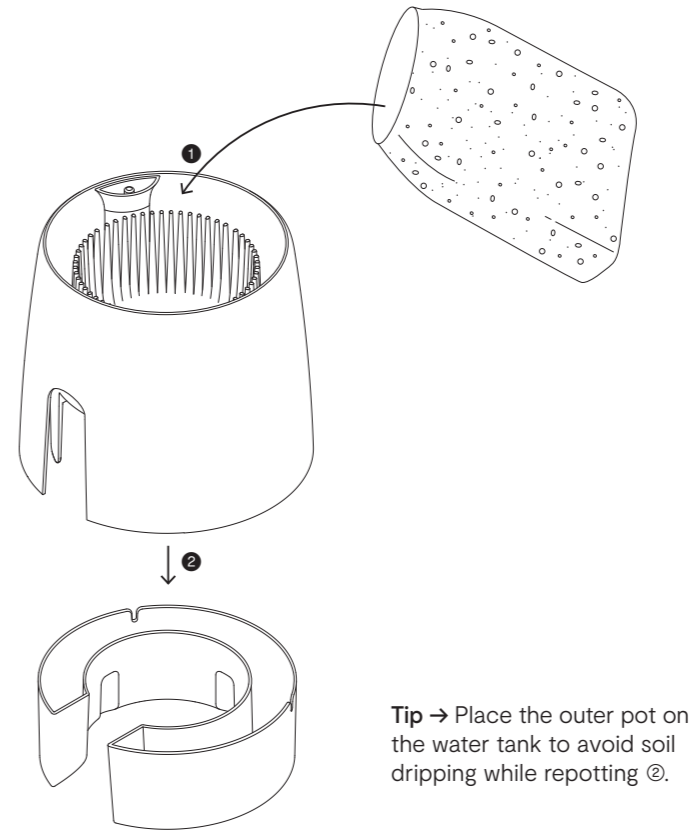

Fill the empty space between the pot and the inner basket up to the tips with expanded clay ①.

4 → re-pot

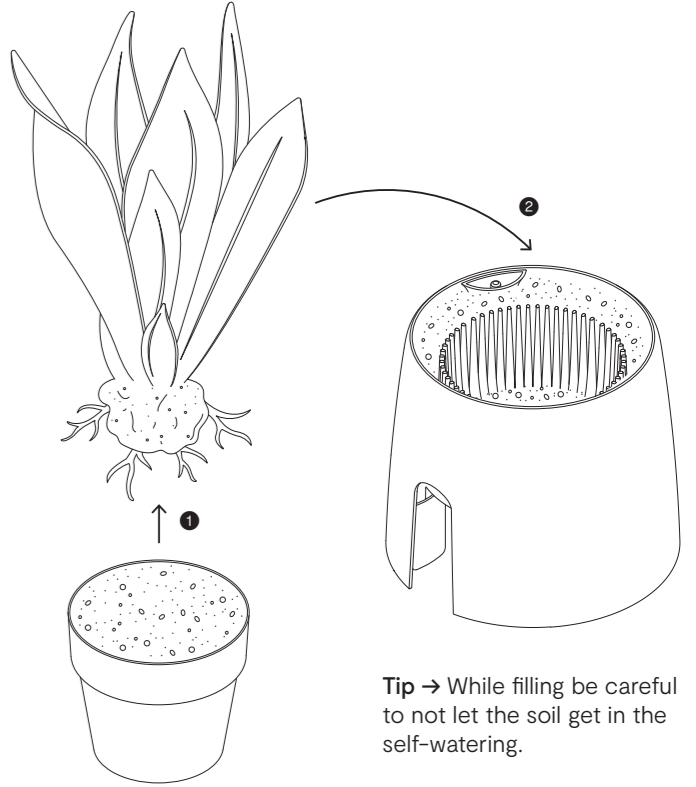

Take the plant out of its pot and gently disentangle the roots ①. Place it in the inner basket, fill with soil and water it ②. Cover the surface with expanded clay, to keep everything neat and tidy.

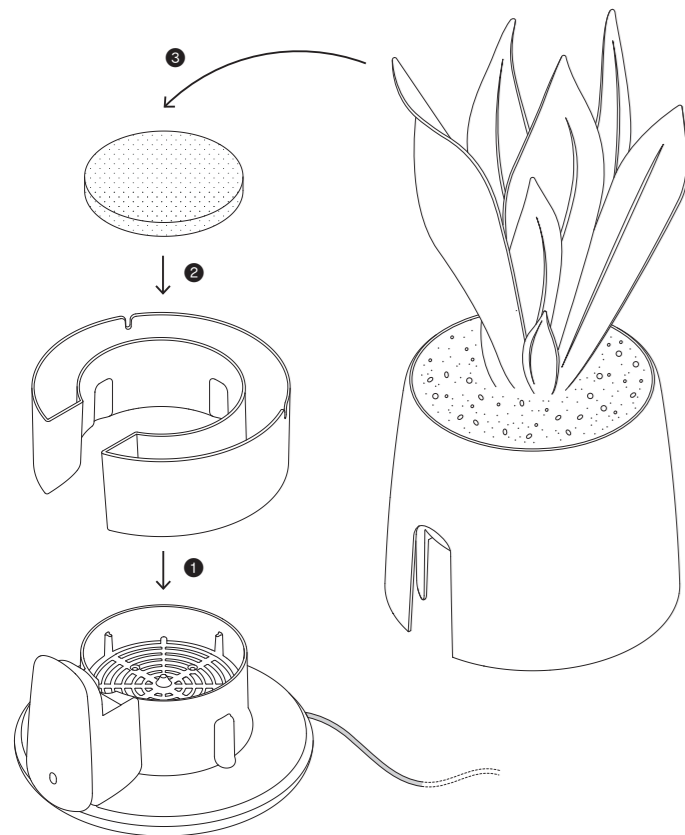

Clean and insert the water tank ① with the ceramic filter ② in its place over the grid. Then put back the outer pot on the base ③.

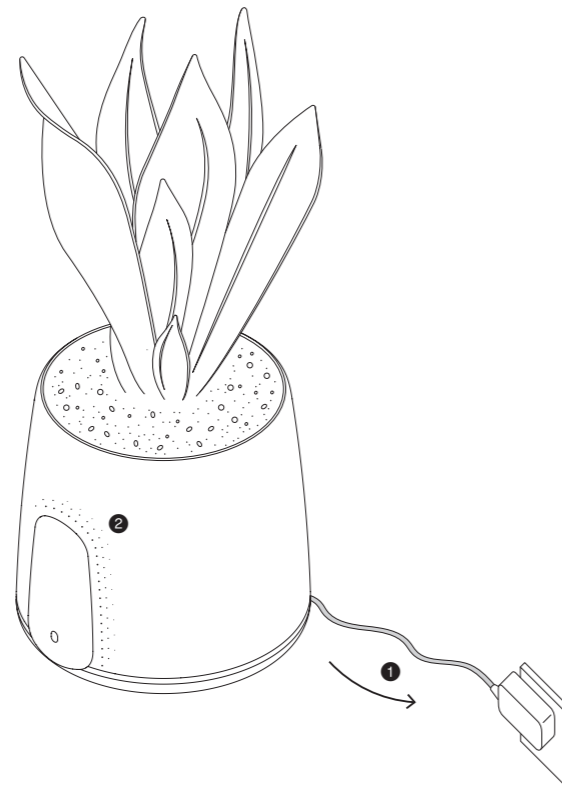

Now it's time to plug in the power supply ①. Wait until the LED on your smart interface blinks twice ②.

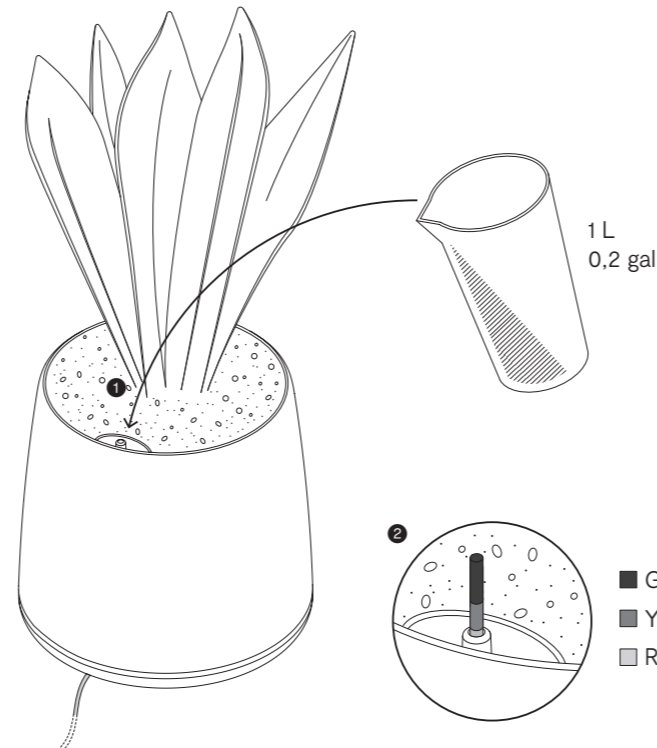

Fill the tank slowly through the spout ①. Pause every seconds to allow the float to rise and check the level. When the green line is visible the tank is half full and when you see the yellow it's full. Make sure to not get over the red line ②.

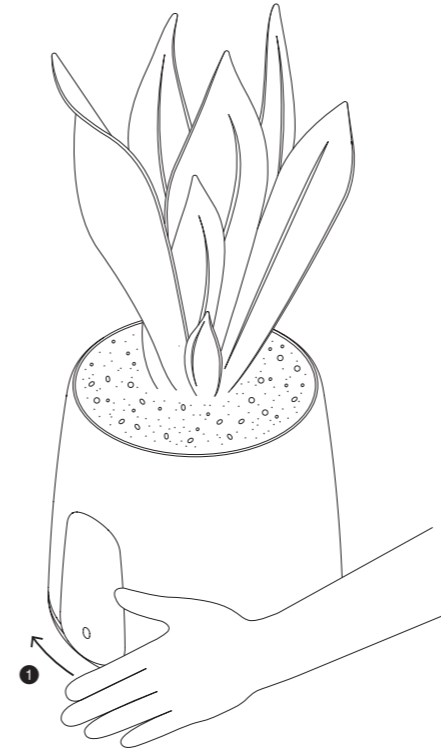

Hold your hand in front of the little eye on the smart interface ① and wait for the magic to start.

→ Download Natede app on the App Store or Play Store. Connect Natede to your smartphone or tablet and follow the instructions to explore all the incredible features of Natede.

Available on:



Say hello to Natede